

Bevel gears Series 444F6../446F6../456F6..

Installation and rotation direction

Front-mounted rolling shutter

Built-in rolling shutter

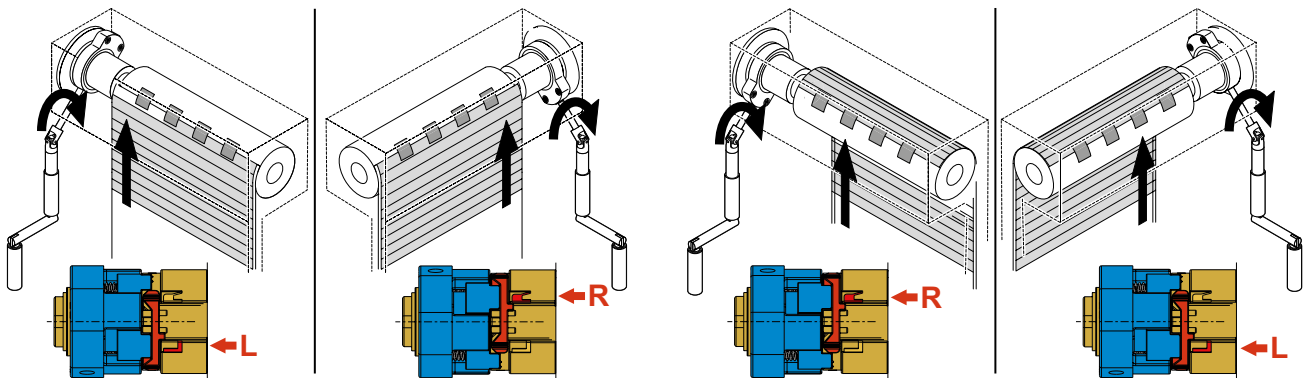

Switching of the rotation direction



For gears pre-set for right fitting, turn tube drive to the right ...

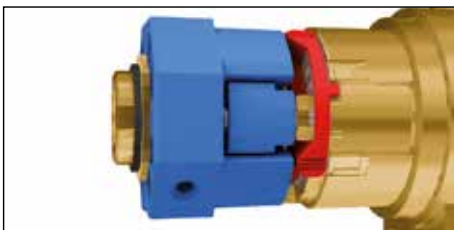

... until the latching elements of the overrun clutch are released and the switch mechanism is free (before the overrun clutch locks in again!)



Turn switch mechanism to the left until it stops ...



... and turn tube drive to the left until the latching elements of the overrun clutch snap into place.

Quick assembly system

1. Fitting of the bracket

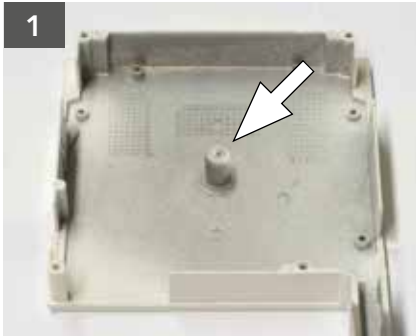

Since the trunnion of the bracket is too high ...

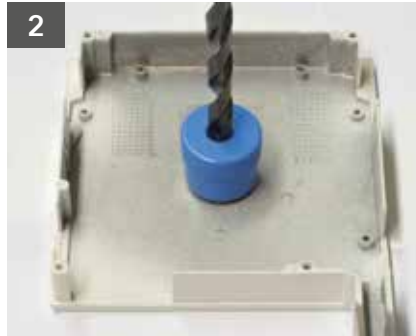

... it must be shortened to the dimension of 8,5 mm. Please use therefore the GEIGER assembly aid 444F500.

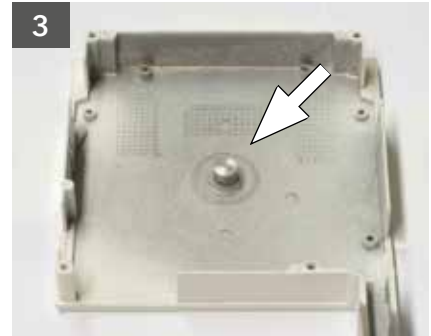

When the trunnion has been reduced to the specified dimension, you can proceed with the gear installation.

2. Installation of the bevel gear with the quick assembly system

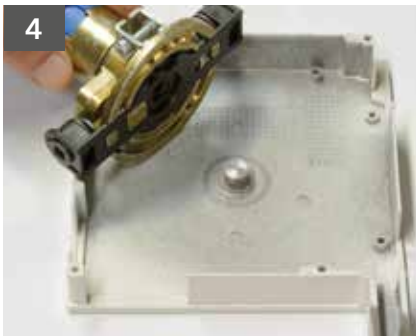

Place the bevel gear with the quick assembly system and the clamping plate on the trunnion.



Align roughly the gear with the drive rod (45° or 90°)

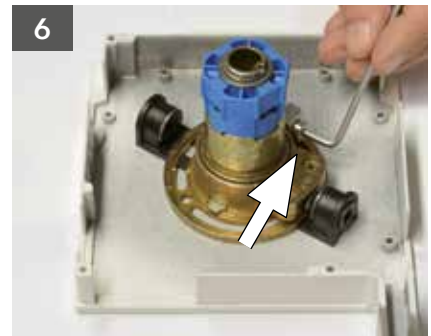

Tighten the screw on the clamping plate (screwable from both sides) with a 3 mm Allen key.
Tightening torque: 3-4 Nm.

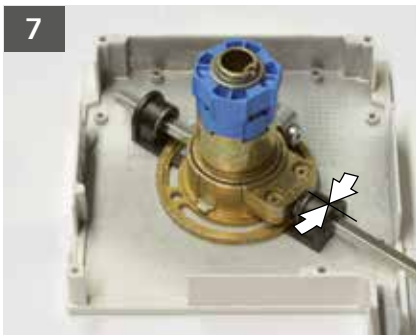

The final alignment with the drive rod is made on site **without** removing the clamping screw.

For technical questions, please call our service team at: +49 (0) 7142 938-333. They will be happy to assist you.

