

## Assembly instructions Angle Adjustment Gear 486F...

Kit No. 486F...  
For axle tube  40

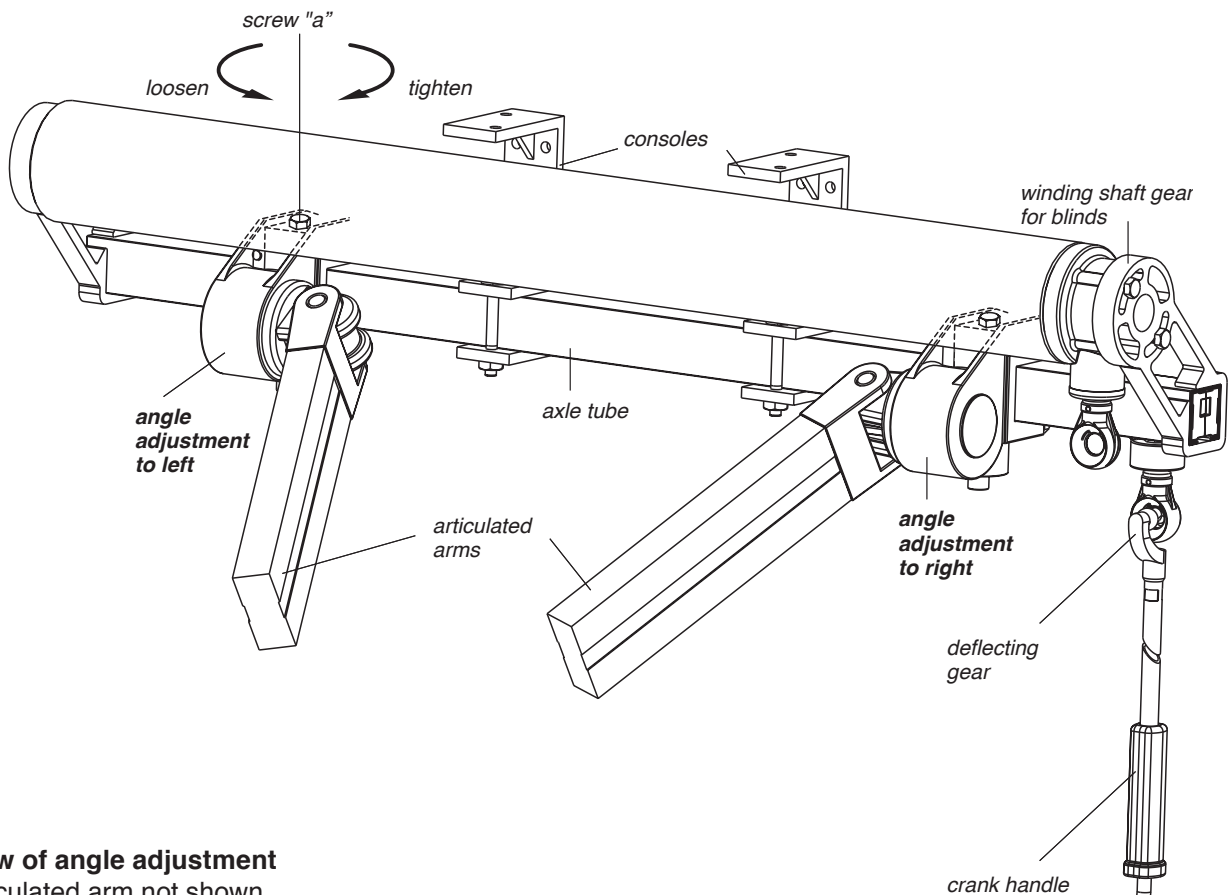

### View of angle adjustment Articulated arm not shown

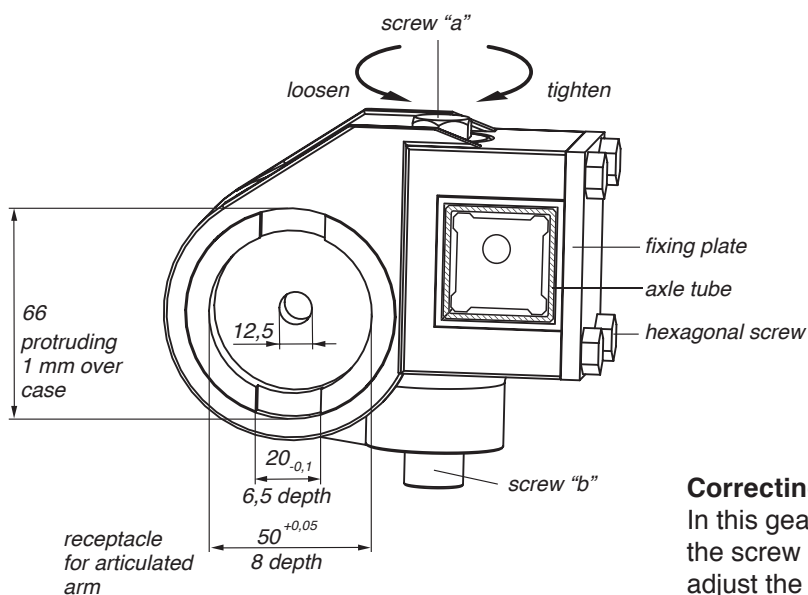

### Correcting the angle of an articulated arm:

In this gear, the connection is broken by loosening the screw "a". Turn screw "b" with an Allen key to adjust the articulated arm to a parallel position and then tighten screw "a" again.