

## 1: GF0020 Touches de commande

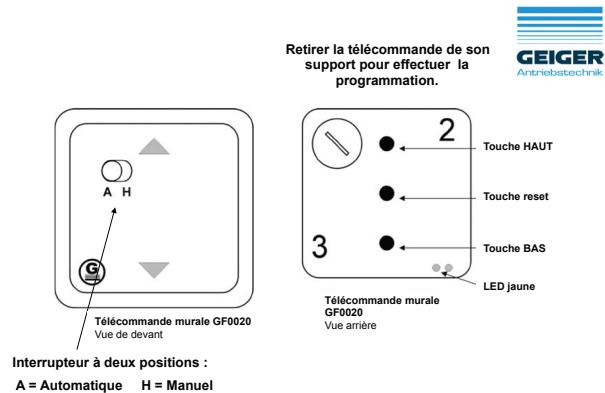

## 2: Programmation du code radio:

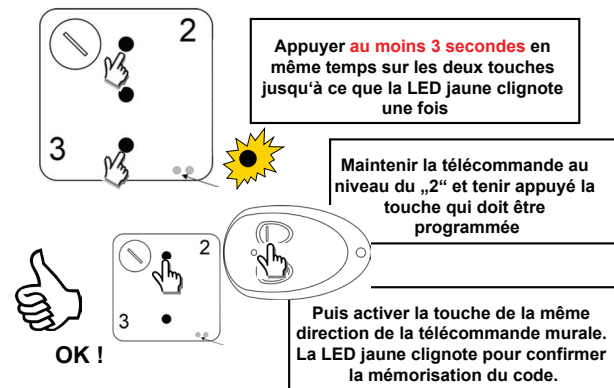

## 3: Programmation du récepteur avec la télécommande murale:

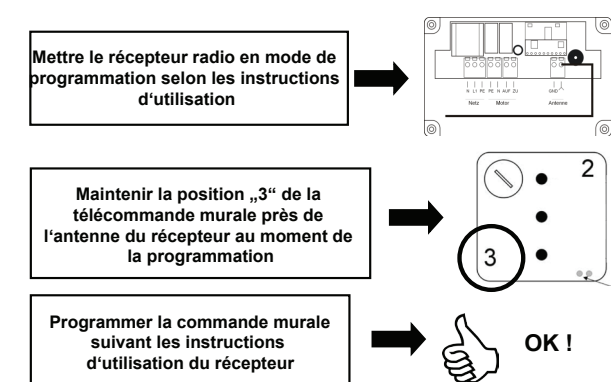

## 4: Programmation des temps de commutation (ouverture):

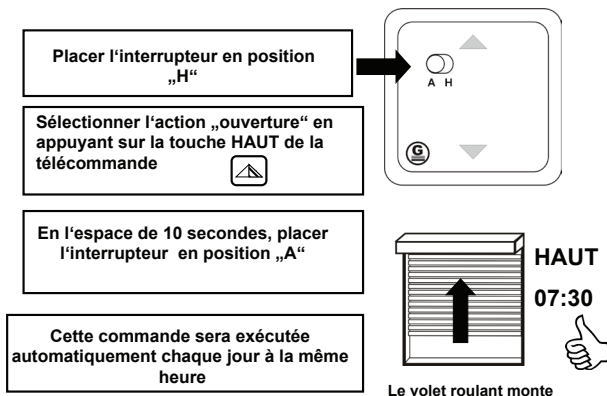

## 5: Programmation des temps de commutation (fermeture)

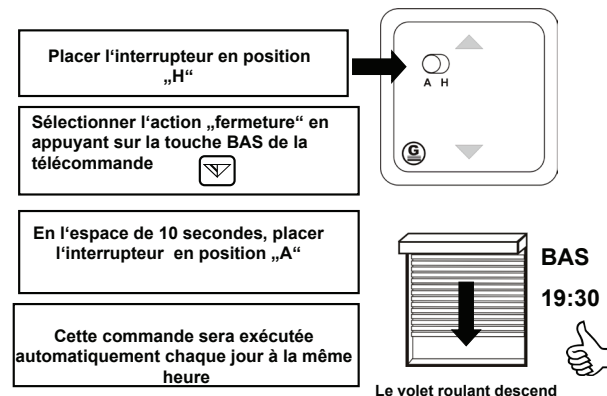

## 6: Programmation spéciale weekend:

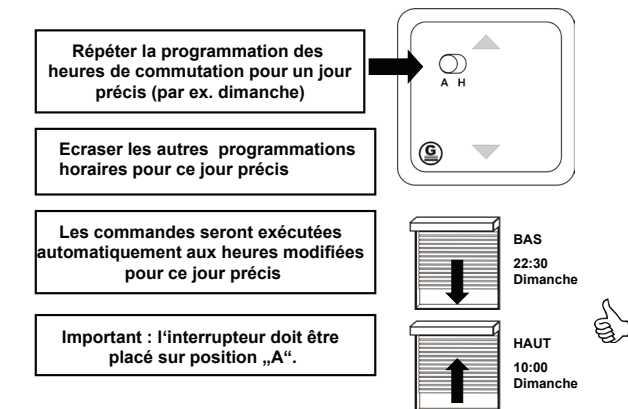

## 7: Passage à l'heure d'hiver:

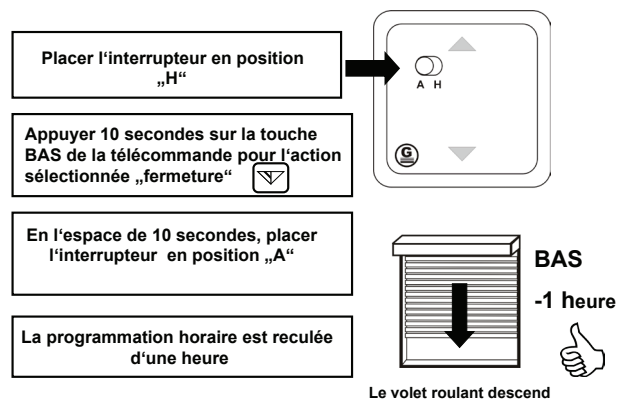

## 8: Passage à l'heure d'été:

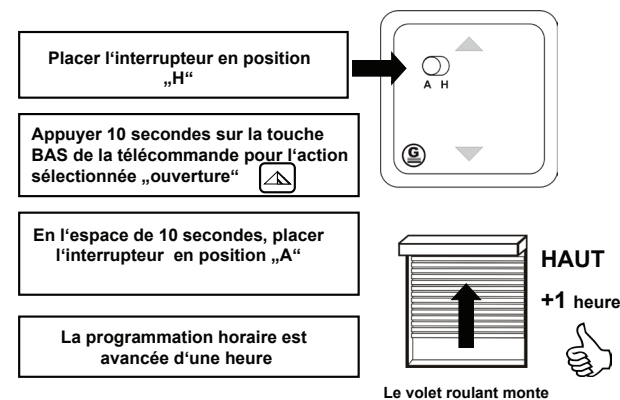

## 9: Suppression de toutes les programmations horaires:

