

Anti-lift device

1. From mini to maxi profile

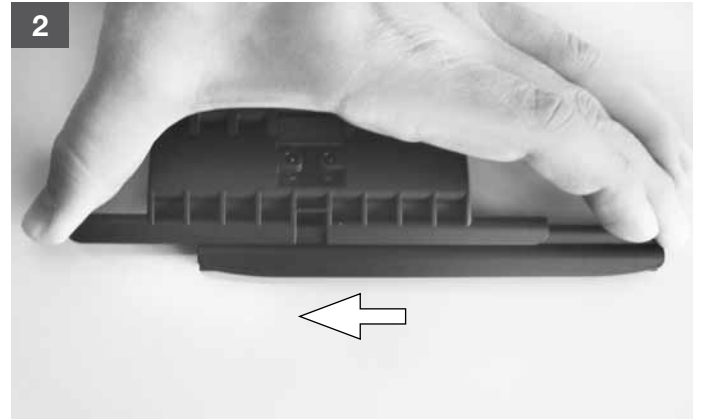

For anti-lift devices with maxi profile please use the enclosed adapter.



Push the adapter on the anti lift device until it clicks into place!
Finished!

2. Assembly

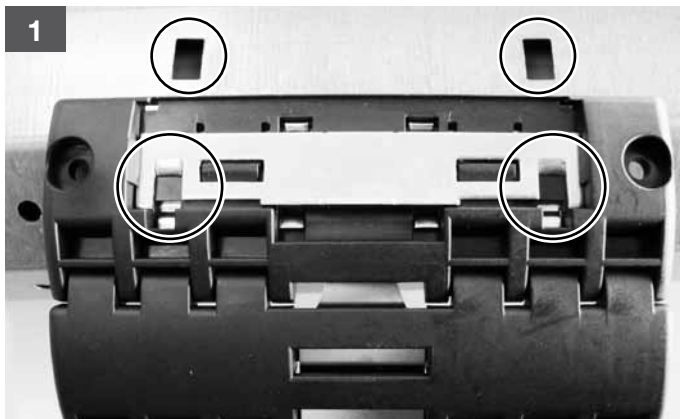

Place both clips on the rectangular holes of the tube.

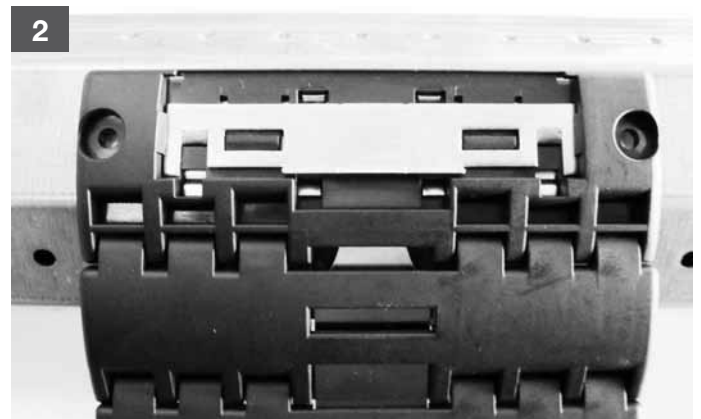

Insert both clips in the openings and pull downwards the anti-lift device.

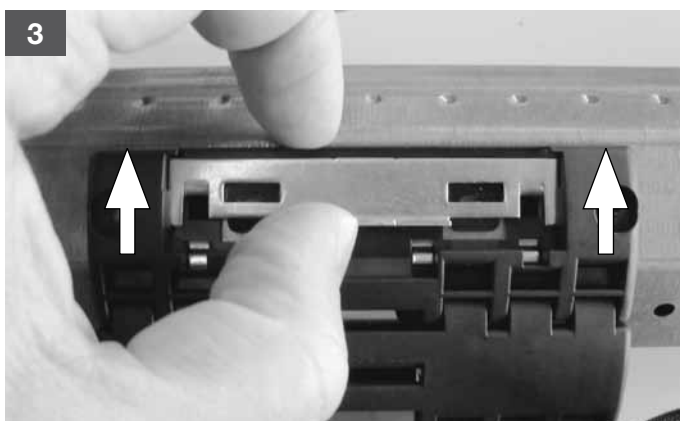

Lift the locking clip up ...

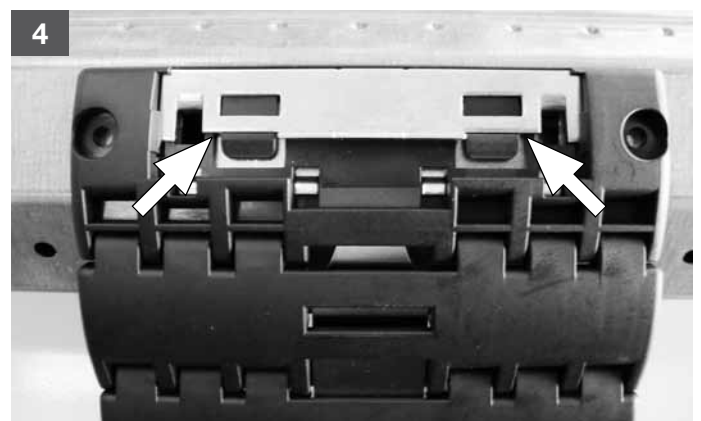

... until it snaps into place.

3. Removal

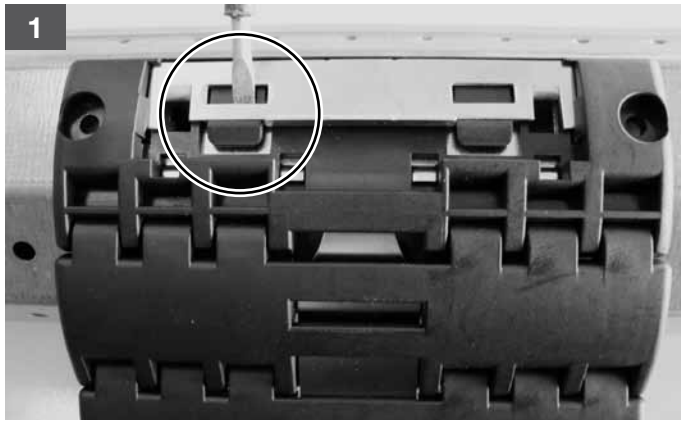

Press the plastic clip downwards with a suitable screwdriver.

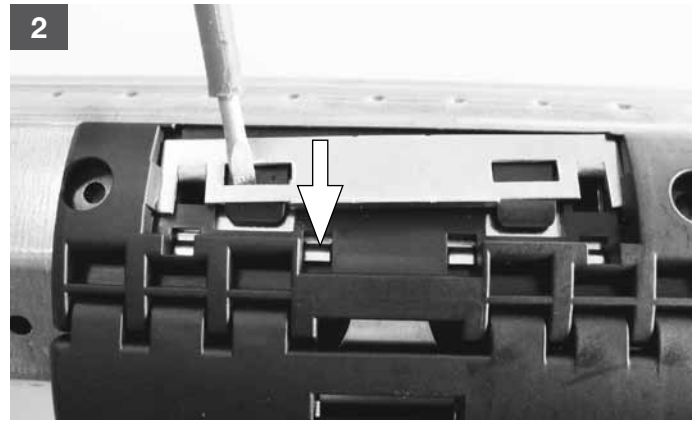

Then push it downwards.



Repeat this procedure with the second clip.

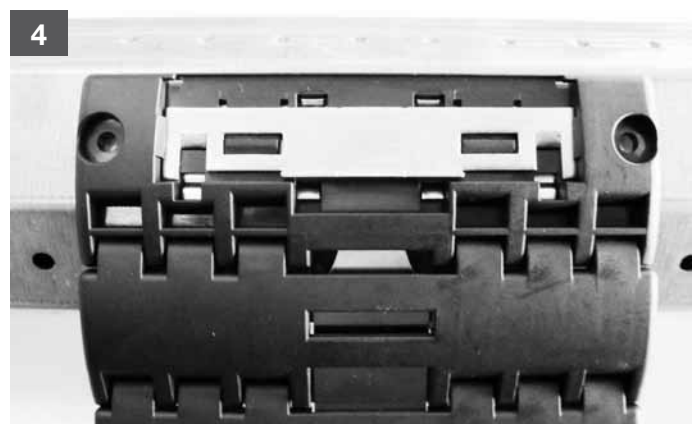

Anti-lift device is now loose on the tube ...



... and may be removed.

For technical questions, please call our service team at: +49 (0) 7142 938-300. They will be happy to assist you.



Gerhard Geiger GmbH & Co.
Schleifmühle 6
D-74321 Bietigheim-Bissingen
Phone +49 (0) 71 42 / 938-300 (Sales)
Fax +49 (0) 71 42 / 938-230
www.geiger-antriebstechnik.de
info@geiger-antriebstechnik.de