

GEIGER

PARTNER TO THE SUN

Tubular motor:

GEIGER-SOLIDline-MOR

Motor control:

GEIGER-Spindle

for rolling shutters, awnings and screens

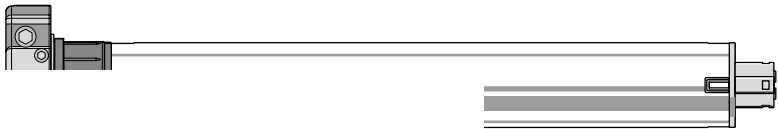

EN

**Original assembly and
operating instructions**

EN

Index

1. General information	3
2. Guarantee.....	3
3. Safety information	3
4. Intended use	4
5. Installation instructions	5
6. Setting of the end stops.....	6
7. Declaration of conformity.....	7
8. Information for the specialist electrician	7
9. Notes on waste disposal	7
10. What to do if...	8

Technical data

Technical data tubular motor SOLIDline-MOR (GU45..)

	GU4510	GU4520	GU4530	GU4540	GU4550
Voltage	230V~/50Hz				
Current	0,47 A	0,63 A	0,8 A	1,0 A	1,0 A
Cos Phi (cosφ)	>0,95				
Inrush current (factor)	x 1,2				
Power	105 W	140 W	180 W	220 W	220 W
Torque	10 Nm	20 Nm	30 Nm	40 Nm	50 Nm
Speed of rotation	16 1/min	16 1/min	16 1/min	16 1/min	12 1/min
Protection type	IP 44				
Total length	611 mm	641 mm	661 mm	681 mm	681 mm
Operating type	S2 4 min	S2 5 min	S2 4 min	S2 4 min	S2 4 min
Diameter	45 mm				
Limit switch range	22 rotations				
Crank reduction	24:1				
Weight	approx. 3,10 kg	approx. 3,40 kg	approx. 3,60 kg	approx. 3,90 kg	approx. 3,90 kg
Storage temperature/ Humidity	T = -15°C .. +70°C / dry and non-condensing place				

Subject to technical modifications. Please find information to the ambient temperature range of our GEIGER motors under www.geiger.de



EN

1. General information

Dear customer,

By purchasing a GEIGER tubular motor you have decided on a quality product from GEIGER.

Thank you very much for your decision and the confidence placed in us.

Before you put this drive into operation please observe the following safety information. It serves for the prevention of danger and for the avoidance of personal injury and damage to property.

Please retain this information for future reference.

- ▶ **Suitable for all rolling shutter systems and screens**
- ▶ **Suitable for all folding arm awnings**
- ▶ **Installation without stops possible**

2. Guarantee

In the case of incorrect installation contrary to the operating instructions and/or constructional modification, the legal and contractual guarantee for property damage and product liability lapses.

3. Safety information



ATTENTION: Important safety information. For personal safety, it is important to follow these instructions. The instructions should be kept.

- ▶ **This appliance is not to be used by persons (including children) whose physical, sensorial or mental capacities are impaired, or who have no experience or know-how, unless they have been supervised or been given instructions on the use of the appliance by someone who is responsible for their safety.**
- ▶ **Children must be supervised to make sure they do not play with the appliance.**
- ▶ **The installation is to be checked regularly for defective balance, wear and damage.**
- ▶ **Damaged connecting leads must be replaced by the GEIGER connecting lead of the same wire type.**
- ▶ **During operation observe the danger zone.**
- ▶ **If people or objects are in the danger zone, do not use the installation.**
- ▶ **Urgently shut down damaged installations until repair.**
- ▶ **Unconditionally shut down the unit during maintenance and cleaning operations.**
- ▶ **Pinching and shearing sites are to be avoided and to be safeguarded against.**
- ▶ **When operating the manual actuator with the open sun protection system, exercise caution as it can fall down quickly if springs expand or are broken.**
- ▶ **Do not operate the device if operations such as, for example, window cleaning are to be carried out in the vicinity.**
- ▶ **Disconnect the device from the mains power supply if operations such as, for example, window cleaning are being carried out in the vicinity.**

EN



ATTENTION: Important safety information. Follow all installation instructions, as incorrect installation can lead to serious injuries.

- ▶ **Connection must be carried out by a skilled electrician according to the regulations in force locally.**
- ▶ **The mains plug of the tubular motor must be accessible after installation.**
- ▶ **On the installation of the tubular motor without mechanical protection of the driven parts, the tubular motor must be installed at a height of at least 2.5 m above the ground or of another level which provides access to the drive.**
- ▶ **Before the tubular motor is installed, all leads which are not needed are to be removed and all equipment which is not needed for actuation is to be put out of operation.**
- ▶ **If the tubular motor is controlled by a switch or pushbutton, the switch or pushbutton must be mounted within eyeshot of the tubular motor. The switch or pushbutton must not be located in the vicinity of moving parts. The height of installation must be at least 1.5 m above the floor. If the apparatus is equipped without a pin and a socket connector (STAS3K) in the connecting lead, or other means for disconnecting from the mains with at least a 3 mm contact opening on each pole, a disconnecting device of this type must be incorporated into the permanently installed electrical installation according to the wiring rules.**
- ▶ **Permanently installed control devices must be attached visibly.**
- ▶ **The correct dimensioning of the drive is to be observed.**

4. Intended use

The tubular motors of the model range **SOLIDline-MOR** with the **Spindle** system are designed exclusively for the operation of rolling shutters, awnings and screens.

If the tubular motors are used for other applications and/or modifications are performed to the tubular motors, which have not been discussed with GEIGER Antriebstechnik, then the manufacturer is not liable for personal injury and/or damage to property and for consequential damage.



If the motor is already installed in the system, the sun protection may only be moved by means of the SOLIDline MOR or operated manually by crank. No other types of drives (for example, a cordless screwdriver) are permitted because they might cause damage to the limit stop.

5. Installation instructions

Before fixing, the strength of the masonry or of the subsurface is to be checked.



Prior to installation please check to ensure there is no visible damage to the motor like cracks or open cables.



Caution: If the tube is screwed/riveted to the drive, the measure must be taken from the tube end to the center of the drive and marked on the tube.

When inserting into the shaft, the tubular motor must **not** be struck and must **not** be allowed to fall into the shaft.

When drilling the winding shaft never drill into the area of the tubular motor!

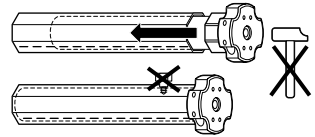

Installation into the rolling shutter:

Fix the engine bearer into the shutter box.

Following options are available:

- Star-shaped engine bearer (M45F889)
- Fixation plate (M45F395)
- Clamp engine bearer (M45F885)
- Square bracket fixation (M45F397)

Insert the motor into the shaft with a suitable adapter/drive up to the stop of the shaft adapter.

Insert the roller capsule on the opposite side.

Screw the square fixation (M45F396) with the motor head.

On the opposite side pull out the roller capsule until the bolt fits into the ball bearing.

Screw together the roller capsule with the shaft.

Screw together the shaft with the tube drive.

Secure the rolling shutter curtain to the shaft.

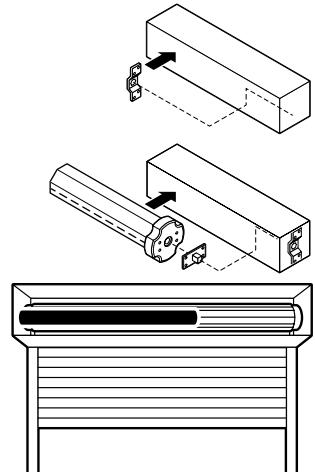

Alternative: screw the motor directly to the bracket (pitch circle 48 mm).

Installation into awnings and screens:

Insert the motor into the shaft with a suitable adapter/drive up to the stop of the shaft adapter.

If available insert eyelet with extension into the motor head and secure with Allen screw.

Fix the engine bearer to the awning.

Following options are available:

- Star-shaped engine bearer (M45F889)
- Fixation plate (M45F395)

Fix the motor together with the shaft on the engine bearer and secure.

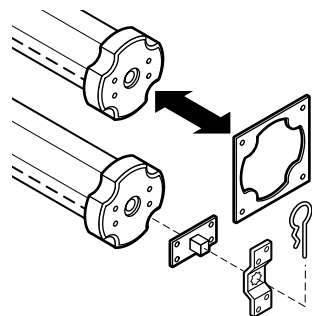

The GEIGER SOLIDline motor is suitable for shaft diameters from 50 mm!

EN

6. Setting of the end stops



CAUTION: In the factory setting, the motor can make 2 rotations in both directions.

Setting the upper end position

Press the UP key until the hanging automatically stops.

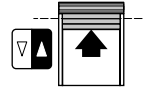

Depending on the installation, turn the corresponding setting screw while pressing the UP key in PLUS direction until the selected upper end position is reached.

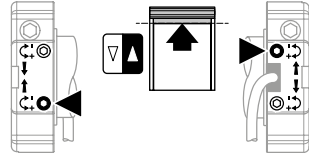

In case the upper end position is overrun (the motor switches off too late):

- Press the DOWN key until the hanging is below the selected end position.
- Turn the setting screw a few turns in the direction opposite the PLUS direction and repeat the above procedure again.

Setting the lower end position

Press the DOWN key until the hanging automatically stops.

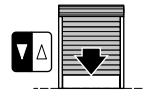

Depending on the installation, turn the corresponding setting screw while pressing the DOWN key in PLUS direction until the selected lower end position is reached.

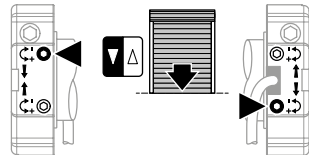

In case the lower end position is overrun (the motor switches off too late):

- Press the UP key until the hanging is above the selected end position.
- Turn the setting screw a few turns in the direction opposite the PLUS direction and repeat the above procedure again.

7. Declaration of conformity

We herewith explicitly declare that this product complies with the essential requirements and relevant directives. It is authorised for use in all EC member states and in Switzerland without any need of prior registration. The Declaration of Conformity concerning this product is available on our website: www.geiger.de.

8. Information for the specialist electrician



Caution: Wrong installation and wrong connection can lead to serious injuries.

Because of back-voltage of the capacitor, the parallel connection of the **SOLIDline-MOR Spindle** is not permissible.

Please do not use any installation switch which allows simultaneous up and down controls.

Connecting cables with plug connectors of the Hirschmann Company, type STAS 3K, may only be used in connection with the Hirschmann cable socket STAK 3K.

9. Notes on waste disposal

Recycling of packaging materials

In the interest of environmental protection, please contact your local government's recycling or solid waste management department to learn more about the services it provides.

Waste disposal of electric and electronic equipment

Electronic equipment or batteries cannot be discarded along with the normal household waste. Keep for more information on the recycling and disposal methods envisaged by the local regulations in your area.

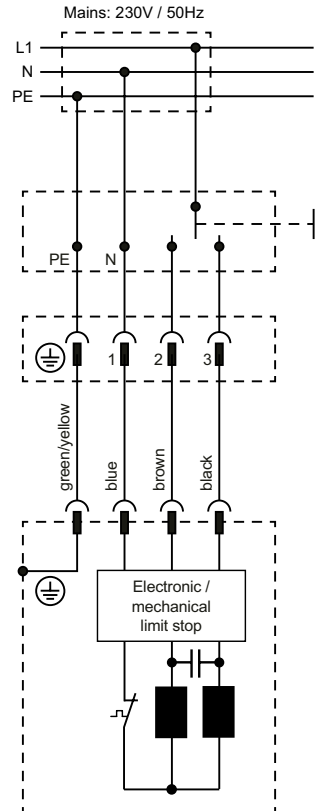

EN

10. What to do if...

Problem	Solution
Motor does not run.	<ul style="list-style-type: none"> • Motor not plugged in. Please check the plug connection. • Check connecting cable for possible damage. • Check the mains voltage and allow the cause of the voltage breakdown to be tested by a specialist electrician.
Instead of in the upwards direction, motor runs downwards.	<ul style="list-style-type: none"> • The control leads are interchanged. Exchange black/brown control leads.
Motor only runs in one direction.	<ul style="list-style-type: none"> • Motor in the end position. Run motor in the opposite direction.
After running several times, the motor breaks down and no longer responds.	<ul style="list-style-type: none"> • The motor became too hot and has switched off. Try it again after a cooling time of about 15 min.
The adjusted end position is not correct.	<ul style="list-style-type: none"> • Reset the end position with the setting screw • Actuator does not rotate simultaneously. Push shaft onto tube actuator, repeat adjustment process.

EN

For technical questions, please call our service team at: **+49 (0) 7142 938-333**. They will be happy to assist you.

GEIGER

PARTNER TO THE SUN

Gerhard Geiger GmbH & Co. KG

Schleifmühle 6

D-74321 Bietigheim-Bissingen

Telephone: +49 (0) 7142 938-0

Telefax: +49 (0) 7142 938-230

E-Mail: info@geiger.de

Internet: www.geiger.de

