

# GEIGER

## ANTRIEBSTECHNIK

Venetian blind motor:

### **GEIGER GJ56.. with mechanical end stop**

For Venetian blinds and exterior blinds

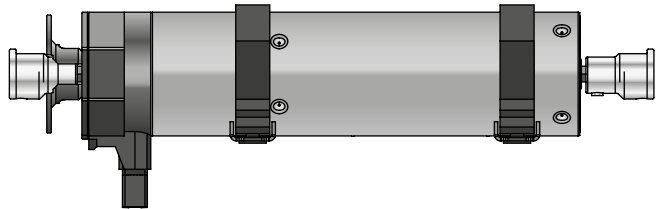

EN

**Original assembly and  
operating instructions**

EN

# Index

1. General information .....	2
2. Guarantee .....	2
3. Intended use .....	2
4. Safety instructions .....	3
5. Safety instructions for assembly .....	3
6. Assembly note .....	4
7. Installation instructions .....	5
8. Information for the specialist electrician .....	7
9. Setting of the end stops .....	7
10. What to do if.....	8
11. Maintenance .....	8
12. Technical data .....	9
13. Declaration of conformity .....	10
14. Notes on waste disposal .....	11

## 1. General information

Dear customer,

By purchasing a GEIGER motor you have decided on a quality product from GEIGER.

Thank you very much for your decision and the confidence placed in us.

Before you put this drive into operation please observe the following safety instructions. It serves for the prevention of danger and for the avoidance of personal injury and damage to property.

The installation and operating instructions contain important information for the installer, the specialist electrician and the user. Please pass on these instructions if you transfer the product. These instructions should be kept by the user.

## 2. Guarantee

In the case of incorrect installation contrary to the installation and operating instructions and/or constructional modification, the legal and contractual guarantee for property damage and product liability lapses.

## 3. Intended use

The motors of the model range GJ56.. with mechanical end stop are designed exclusively for the operation of Venetian blinds.

The motors may not be used for the operation of roller grilles, garage doors, furniture and lifting tools.

GJ 56 xx x  
| | | |  
| | | | Design options  
| | | | Torque in Nm  
| | | | For head rails at least 56 mm  
| | | | GEIGER Venetian blinds motor

EN

## 4. Safety instructions



**ATTENTION:** Important safety instructions. For personal safety, it is important to follow these instructions. Please keep these instructions for future reference.

- ▶ Do not allow children to play with stationary controls. Keep remote controls away from children.
- ▶ The installation is to be checked regularly for defective balance, signs of wear or damaged cables and springs, if relevant.
- ▶ Do observe the moving sun protection system and keep persons away until it has closed completely.
- ▶ When operating the manual release with the sun protection system open, please be cautious as it can fall down quickly if springs or tapes wear off or are broken.
- ▶ Do not operate the device if operations such as, for example, window cleaning are to be carried out in the vicinity.
- ▶ Disconnect the automatic controlled device from the mains power supply if operations such as, for example, window cleaning are being carried out in the vicinity.
- ▶ During operation observe the danger zone.
- ▶ Do not use the installation if people or objects are in the danger zone.
- ▶ Urgently shut down damaged installations until repair.
- ▶ Unconditionally shut down the unit during maintenance and cleaning operations.
- ▶ Pinching and shearing points are to be avoided and must be secured.
- ▶ This appliance can be used by children aged 8 and above and persons whose physical, sensorial or mental capacities are impaired, or who have no experience or know-how if they have been supervised or been given instructions on the use of the appliance and if they understand the possible resulting dangers. Children are not permitted to play with the device. Cleaning and maintenance should not be carried out by children.
- ▶ The rated sound pressure level is less than 70 dB(A).
- ▶ Disconnect the device from the mains power supply for maintenance and replacement of parts.  
If the motor is disconnected via a plug connection the operator must be able to control - from any place to which it has access – that the plug is removed.  
If this is not possible - due to design or installation - the disconnection from the power supply must be ensured via locking in the disconnected position (e.g. isolator).
- ▶ The motor tube can get very hot during prolonged use.  
When working on the unit, do not touch the tube before it has cooled down.

EN

## 5. Safety instructions for assembly



**ATTENTION:** Important safety instructions. Follow all installation instructions, as incorrect installation can lead to serious injuries.

- ▶ When mounting the motor without any mechanical protection of the driven parts and of the tube which may become hot, the motor must be installed at a height of at least 2.5 m above the ground or of another level which provides access to the drive.
- ▶ Before the motor is installed, all cables which are not needed are to be removed and all equipment which is not needed for power-operated actuation is to be put out of operation.
- ▶ The actuating element of a manual release must be mounted at a height of less than 1.8 m.
- ▶ If the motor is controlled by a switch or pushbutton, the switch or pushbutton must be mounted within eyeshot of the motor. The switch or pushbutton must not be located in the vicinity of moving parts. The height of installation must be at least 1.5 m above the floor.
- ▶ Permanently installed control devices must be attached visibly.
- ▶ In case of devices extending horizontally, a horizontal distance of at least 0.4 m must be respected between the fully extended part and any other fixed element.

- ▶ The rated speed and the rated torque of the motor must be compatible with the device.
- ▶ The mounting accessories that are used must be designed in accordance with the selected rated torque.
- ▶ Good technical knowledge and good mechanical skills are necessary for the motor installation. Incorrect installation can lead to serious injury.  
Electrical work must be carried out by a qualified electrician in accordance with the regulations in force locally.
- ▶ Only use connecting cables that are suitable with the environmental conditions and which meet the construction requirements. (see accessories catalogue)
- ▶ If the device is not equipped with a connecting cable and a plug, or other means for disconnecting from the mains with a contact opening on each pole according to the conditions of the overvoltage category III for full disconnection, a disconnecting device of this type must be incorporated into the permanently installed electrical installation according to the wiring rules.
- ▶ Do not mount the connecting cables near hot surfaces.
- ▶ A plug for the disconnection of the motor from the power supply must be accessible after installation.
- ▶ Damaged connecting cables must be replaced by GEIGER connecting cables of the same type.
- ▶ The device must be mounted as described in the installation instructions. Fixations shall not be made with adhesives since they are regarded as unreliable.

## 6. Assembly note

When viewed from inside the room, the power supply connection of the GJ56 is located on the left side. The straps are wound on the winding rollers from the outside. The adjustment buttons of the limit stop control device and the limit stop switch must point downward.

The GJ56 which is set to the lower end position when it leaves the factory, is installed in the fully lowered Venetian blind. Thus, adjusting the lower end position is not required. The GJ56 must be installed in alignment with the turning bars.

It is important that the GJ56.. is installed centrally. Please make sure that the load is evenly distributed.

### Inclined installation:

The inclined installation is permitted till 45° maximum to level. The limit stop switch and the adjustment buttons must point downward.

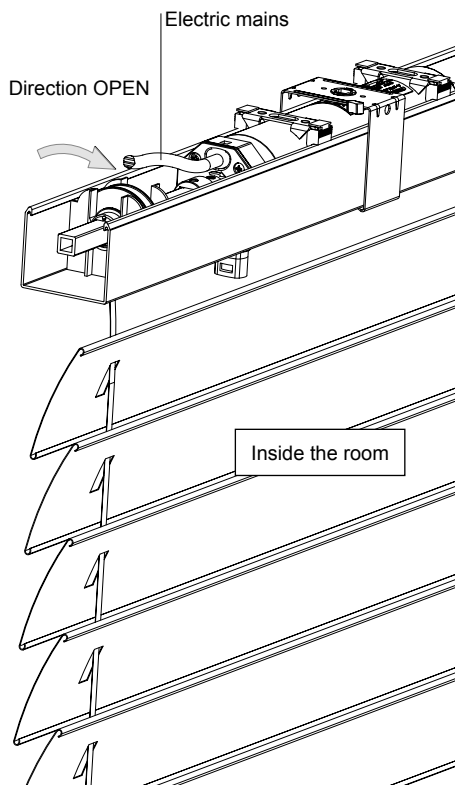

## 7. Installation instructions



Prior to installation please check to ensure there is no visible damage to the motor like cracks or open cables.



Before fixing please check the strength of the masonry and of the surface.

Head rail opening at top:

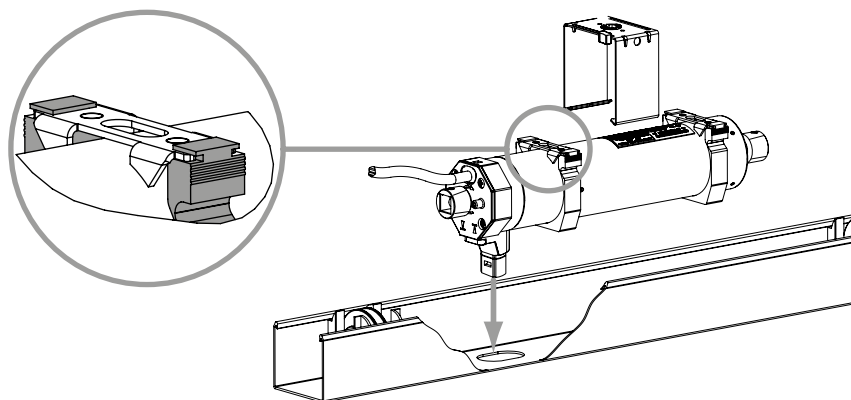
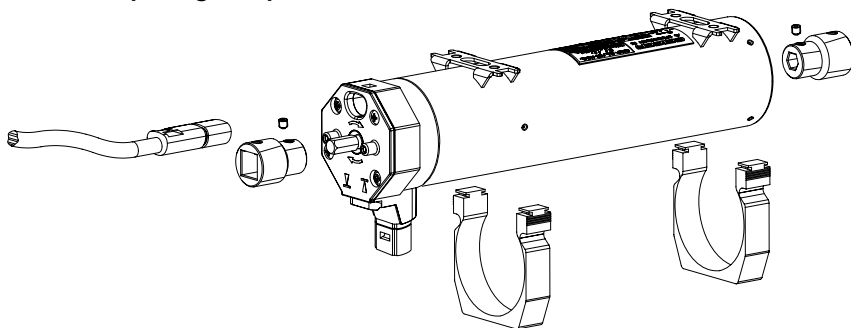

EN

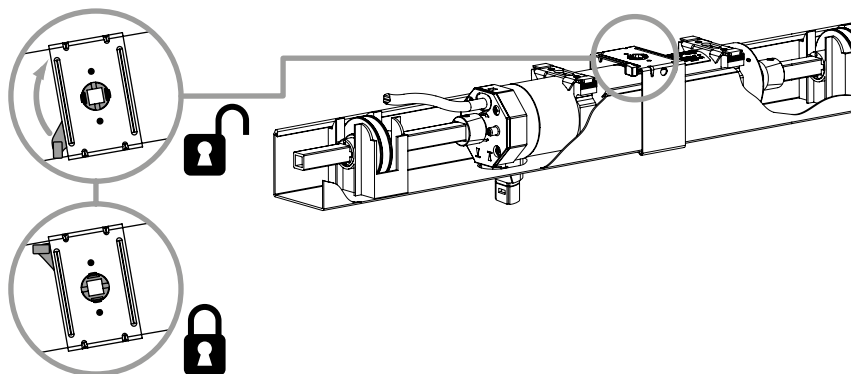

## Head rail opening at bottom:

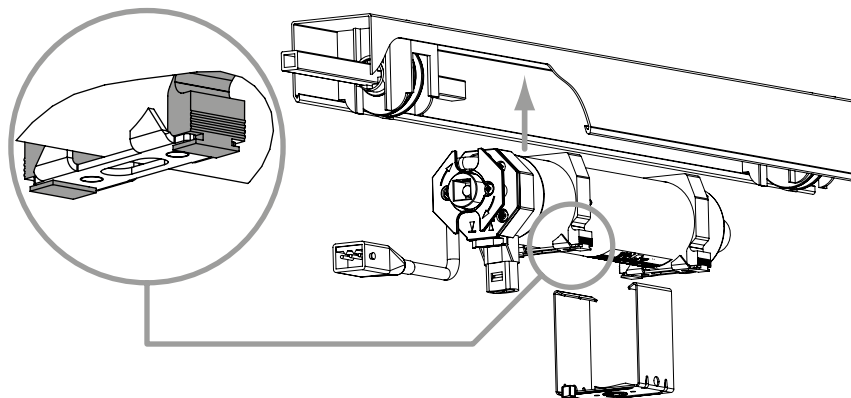
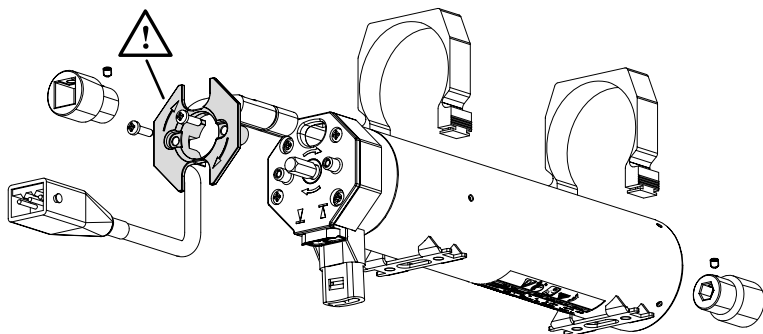

EN

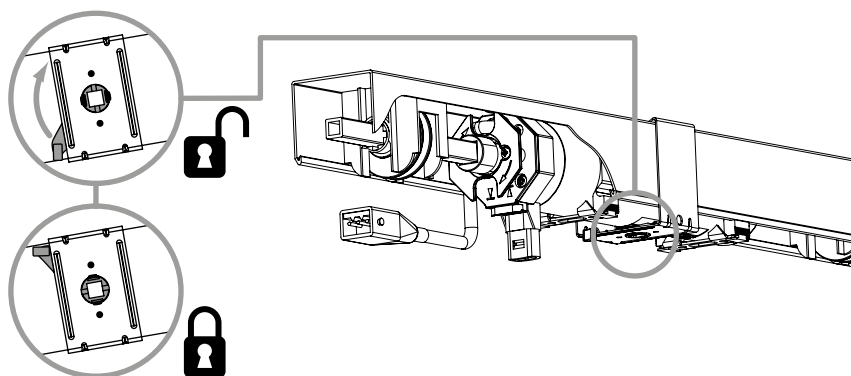

## 8. Information for the specialist electrician



**Caution: Important installation instructions.**  
Please follow all installation instructions since incorrect installation can lead to the destruction of the motor and the switching unit.

The operations with the service clamps may be accomplished only by an electrical specialist.

Motors with mechanical limit stops cannot be connected in parallel but must be connected via a multipolar switch or a cut-off relay.

Switches and controls must not execute simultaneous UP and DOWN commands.

When changing the running direction the switchover must be effected through an off-position.

When changing the running direction the switchover time must be at least 0.5 s.

A voltage rise occurs at the LC unit (coil-capacitor unit) of the auxiliary line. The excessive mains voltage is applied respectively to the non-controlled input.

With a three-phase network, please use the same external conductor in order to control the UP and DOWN directions.

PVC cables are not suitable for equipment used outdoors or exposed to prolonged high levels of UV radiation. These cables should not be used if they are likely to touch metal parts that can heat up to temperatures exceeding 70°C.

Connecting cables with plug connectors of the Hirschmann Company are tested and approved with couplings of the Hirschmann Company.

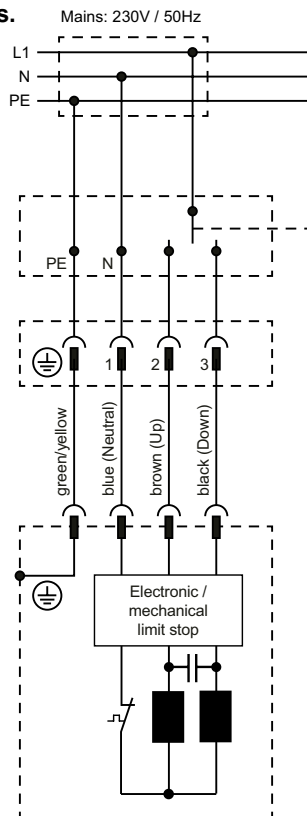

## 9. Setting of the end stops

The GJ56 is equipped with two integrated, adjustable limit switches. If required, the factory settings can be changed at any time as often as you like.



**The GJ56 can only be operated with an installed limit stop switch.**

If required, the GJ56 can be delivered without limit stop switch.

### Operation with limit stop switch

If the GJ56 is to be switched off in the upper end position by means of the limit stop switch, and the GJ56 was installed in the fully lowered Venetian blind as described above, no further settings are required.



**Note:**  
**The limit stop switch will stop the GJ56.. direction OPEN only.**

If you press the DOWN adjustment button for the lower end position and DOWN direction, the Venetian blind can move over the lower turning position and move up again. If the Venetian blind hits the limit stop switch now, the GJ56 is not switched off and the Venetian blind could be damaged.

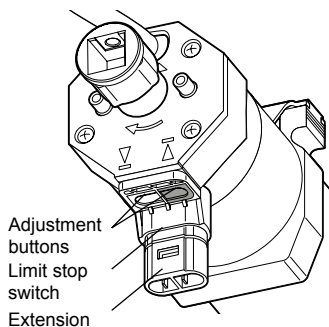

EN

### Adjustment of upper end position

1. Move the Venetian blind approx. 300 mm below the required end position.
2. Press the **black** adjustment button.
3. Move up the Venetian blind to the required end position.
4. Move down the Venetian blind about 6 seconds, until the **black** adjustment button jumps back audibly (click).

**Now the upper end position is adjusted.**

### Adjustment of lower end position

1. Move the Venetian blind approx. 300 mm above the required end position.
2. Press the **white** adjustment button.
3. Move down the Venetian blind to the required end position.
4. Move up the Venetian blind about 6 seconds until the **white** adjustment button jumps back audibly (click).

**Now the lower end position is adjusted.**

## 10. What to do if...

Problem	Solution
Motor does not run.	<ul style="list-style-type: none"><li>• Motor not plugged in. Please check the plug connection.</li><li>• Check connecting cable for possible damage.</li><li>• Check the mains voltage and allow the cause of the voltage breakdown to be tested by a specialist electrician.</li></ul>
Instead of in the upwards direction, motor runs downwards.	<ul style="list-style-type: none"><li>• The control leads are interchanged. Exchange black/brown control leads.</li></ul>
Motor only runs in one direction.	<ul style="list-style-type: none"><li>• Motor in the end position. Run motor in the opposite direction. Readjust the end positions, if necessary.</li></ul>
After running several times, the motor breaks down and no longer responds.	<ul style="list-style-type: none"><li>• The motor became too hot and has switched off. Try it again after a cooling time of about 15 min.</li></ul>
The blind is in the upper end position, actuates the limit stop switch and can no longer move downward.	<ul style="list-style-type: none"><li>• The motor has been installed upside down or the lower end stop has been overrun and the straps are wound up the wrong way. Restore free motion of the limit stop switch. Re-adjust the end positions</li></ul>

## 11. Maintenance

The drive is maintenance-free.



## 12. Technical data

Technical data GJ56.. with mechanical end stop (standard mechanical)				
	GJ5603k	GJ5606k	GJ5610	GJ5620
Voltage	230 V~/50 Hz			
Current	0,40 A	0,40 A	0,60 A	0,85 A
Cos Phi ( $\cos\varphi$ )	> 0,95			
Inrush current (factor)	x 1,2			
Power	90 W	93 W	135 W	190 W
Torque	3 Nm	6 Nm	10 Nm	2 x 10 Nm
Speed	26 rpm			
Protection class	IP 54			
Limit switch range	80 rotations			
Operating mode	S2 4 min			
Sound pressure level <sup>1)</sup>	34 db(A)	34 db(A)	35 db(A)	40 db(A)
Length	299 mm	299 mm	309 mm	336 mm
Diameter	55 mm			
Weight	ca. 1,50 kg	ca. 1,50 kg	ca. 1,70 kg	ca. 2,20 kg
Air humidity	dry and non-condensing place			
Storage temperature	T = -15°C .. +70°C			

Technical data GJ56.. with mechanical end stop (run-time optimized version)		
	GJ5606	GJ5616
Voltage	230 V~/50 Hz	
Current	0,40 A	0,70 A
Cos Phi ( $\cos\varphi$ )	> 0,95	
Inrush current (factor)	x 1,2	
Power	90 W	150 W
Torque	6 Nm	2 x 8 Nm
Speed	26 rpm	
Protection class	IP 54	
Limit switch range	80 rotations	
Operating mode	S2 6 min	
Sound pressure level <sup>1)</sup>	34 db(A)	40 db(A)
Length	304 mm	336 mm
Diameter	55 mm	
Weight	ca. 1,60 kg	ca. 2,20 kg
Air humidity	dry and non-condensing place	
Storage temperature	T = -15°C .. +70°C	

<sup>1)</sup> The average sound pressure level data are intended for guidance only. The values were determined by GEIGER at a distance of 1 m, with a hanging motor at idle speed and averaged over 10 seconds. There is no reference to any specific test standard.

Subject to technical modifications. Please find information to the ambient temperature range of our GEIGER motors under [www.geiger.de](http://www.geiger.de)

## 13. Declaration of conformity

**GEIGER**  
ANTRIEBSTECHNIK

### EU Declaration of Conformity

Gerhard Geiger GmbH & Co. KG  
Antriebstechnik  
Schleifmühle 6  
D-74321 Bietigheim-Bissingen

#### Product designation:

Venetian blinds motor, motor for rolling shutters, motor for awnings

#### Type designation:

GJ56.., GR45.., GU45.., GSI56.., GB45.., GB35..

#### Applied directives:

2006/42/EG  
2014/53/EU  
2011/65/EU + (EU)2015/863 + (EU)2017/2102

#### Applied standards:

EN 60335-1:2012  
EN 60335-1:2012/AC:2014  
EN 60335-1:2012/A11:2014  
EN 60335-1:2012/A13:2017  
EN 60335-1:2012/A1:2019  
EN 60335-1:2012/A14:2019  
EN 60335-1:2012/A2:2019  
EN 60335-2-97:2006+A11:2008+A2:2010+A12:2015  
EN 62233:2008  
EN 62233 Ber.1:2008  
EN 55014-1:2017  
EN 55014-2:2015  
EN 61000-3-2:2019  
EN 61000-3-3:2013

ETSI EN 301 489-1 V2.2.0(2017-03)  
ETSI EN 301 489-3 V2.1.1(2019-03)  
ETSI EN 300 220-2 V3.1.1(2017-02)

DIN EN IEC 63000:2019-05

#### Authorized representative for technical data:

Gerhard Geiger GmbH & Co. KG

#### Address:

Schleifmühle 6, D-74321 Bietigheim-Bissingen

Bietigheim-Bissingen, 20.04.2022

  
Roland Kraus (General Manager)

Gerhard Geiger GmbH & Co. KG

Schleifmühle 6 | D-74321 Bietigheim-Bissingen

Phone +49 (0) 7142 9380 | Fax +49 (0) 7142 938 230 | info@geiger.de | www.geiger.de

Sitz Bietigheim-Bissingen | Amtsgericht Stuttgart HRA 300591 | USt-IdNr. DE145002146

Komplementär: Geiger Verwaltungs-GmbH | Sitz Bietigheim-Bissingen | Amtsgericht Stuttgart HRB 300481

Geschäftsführer: Roland Kraus | WEEE-Reg.-Nr. DE47902323

100W0599en 0422

Current declarations of conformity are available under [www.geiger.de](http://www.geiger.de)

## 14. Notes on waste disposal

### **Recycling of packaging materials**

In the interest of environmental protection, please contact your local government's recycling or solid waste management department to learn more about the services it provides.

### **Waste disposal of electric and electronic equipment**

Electrical and electronic equipment must be collected and disposed of separately in accordance with EU regulations.

**For technical questions, please call our service team at: +49 (0) 7142 938 333.  
They will be happy to assist you.**

**GEIGER**  
**ANTRIEBSTECHNIK**

**Gerhard Geiger GmbH & Co. KG**  
Schleifmühle 6 | D-74321 Bietigheim-Bissingen  
T +49 (0) 7142 9380 | F +49 (0) 7142 938 230  
info@geiger.de | www.geiger.de

