

1: GF0021/-27 Display LCD:

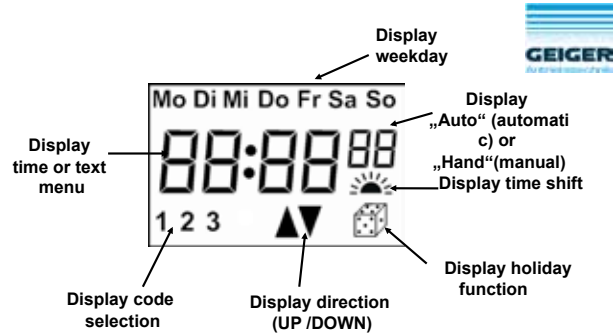

2: GF0021/-27 Operating keys:

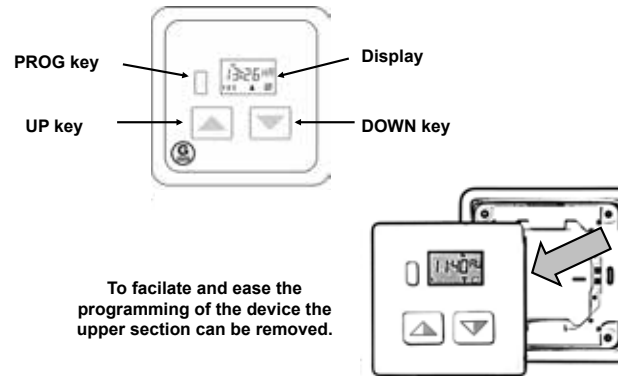

3: GF0021/-27 Operating keys:

- ▶ Actuate the key **PROG** to change over to the programming mode
- ▶ Select menu items with the **UP/DOWN** keys
- ▶ Confirm with the key **PROG**.
- ▶ **Actuate the UP/DOWN keys simultaneously** to cancel all settings that have not been confirmed and exit the programming mode.
- ▶ If no key is actuated, all previously made changes are cancelled after the expiry of a 40 second time and the clock returns to normal mode.

4: GF0021/-27 Menu setup:

In programming mode there is a total of seven menu items. Use UP/DOWN keys to select options.

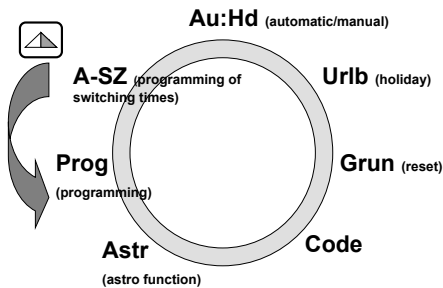

5: Au:Hd (Change-over from manual to automatic mode):

The current operating mode is shown on display (AU / HA)

Actuate key PROG to change over from one mode to the other

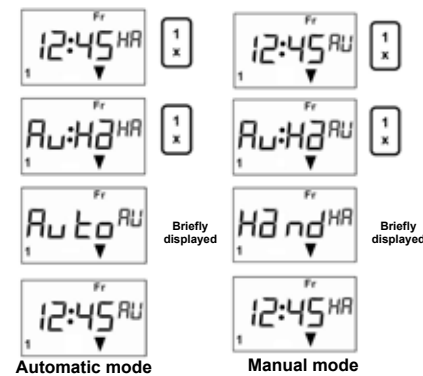

6: A-SZ (Programming of the switching times)

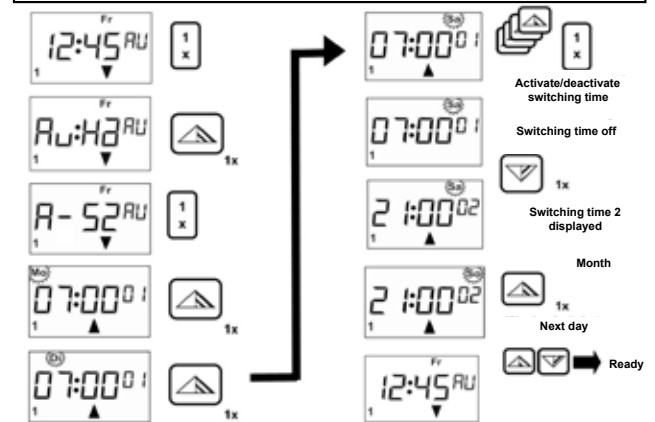

7: Prog (Programming field):

Submenu with 4 options:

- PrSZ = Programming of the switching times
- Zeit = Programming of the time
- datu = Programming of the date
- Lern = Code learning and programming

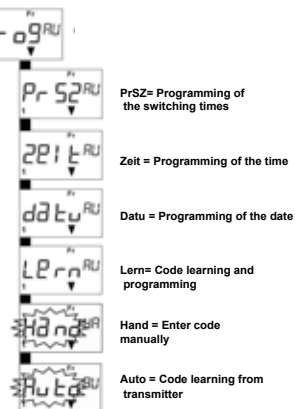

Hand = Enter code manually
Auto = Code learning from transmitter

8: PrSZ (Programming switching time / weekday)

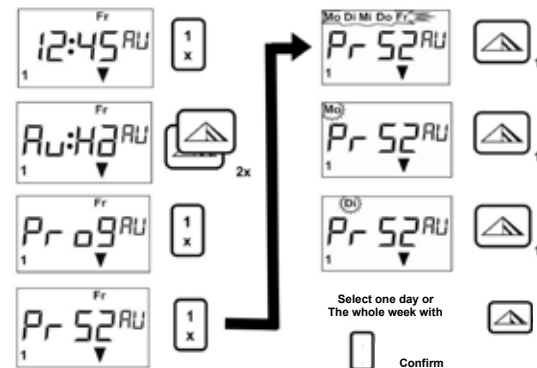

9: PrSZ (Programming of 4 switching times):

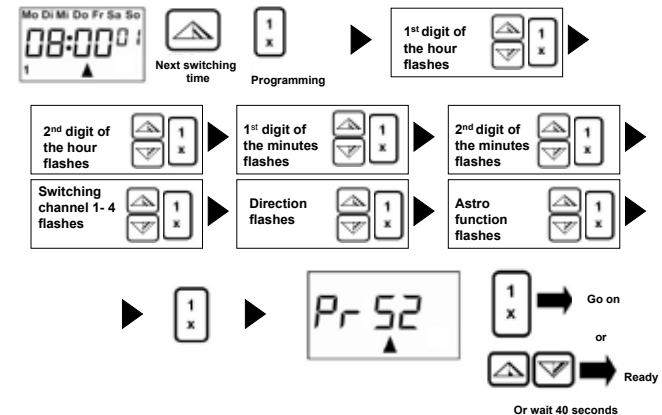

10: Zeit (Setting of the time):

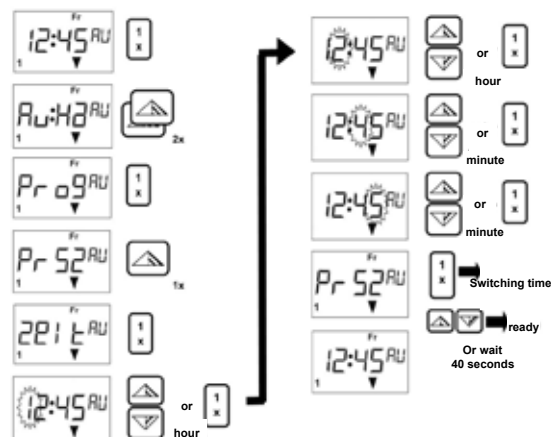

11: datu (Setting of the date):

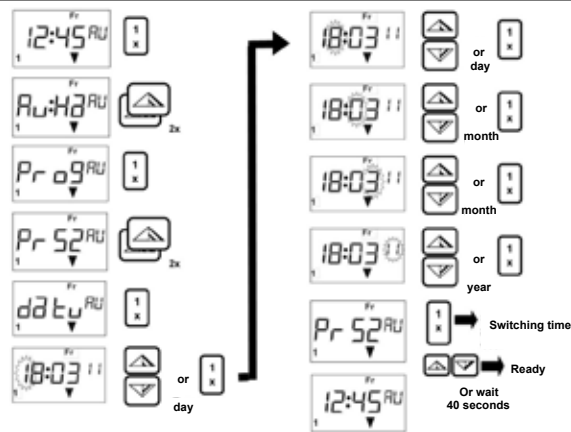

12: Lern (Learning and programming of codes):

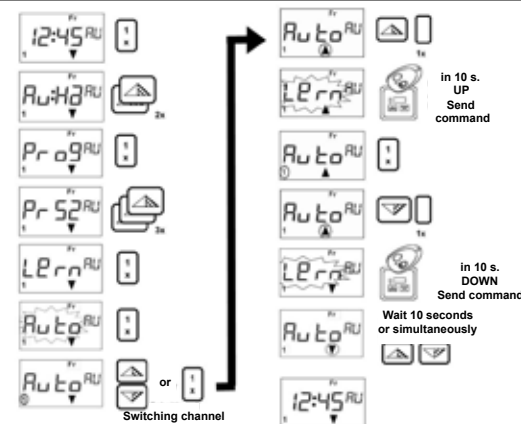

13: Astr (time shift):

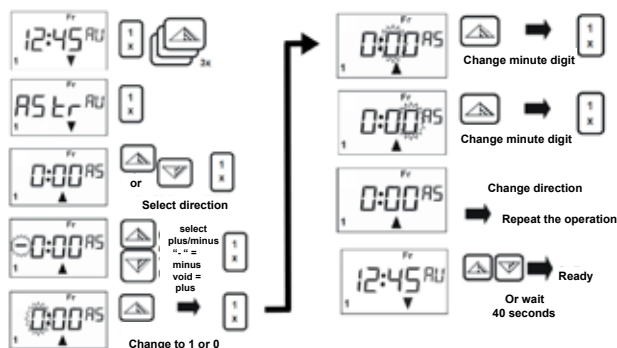

Time shift +/- 1 h 59

14: Astr (Setting of the degree of latitude):

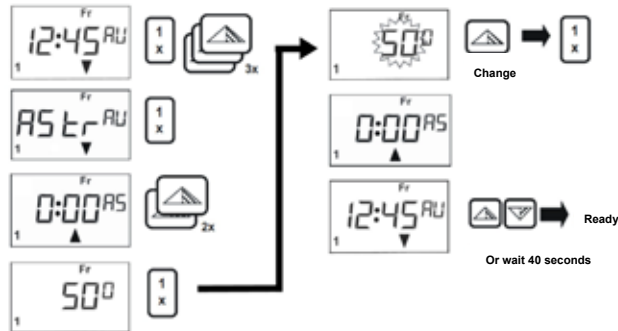

Following values can be programmed :
44, 47, 50, 52, 54, 56, 57, 58, 59, 60 (Standard = 50°)

15: Astr (latitudes / towns):

- 44° - Florenz, Bordeaux, Minneapolis
- 47° - Salzburg, Wien, Angers, Seattle
- 50° - Köln, Mainz, Leipzig, Lilles, Brussels
- 52° - Hannover, Berlin, Amsterdam
- 54° - Hamburg, Vilnius
- 56° - Kopenhagen, Riga
- 57° - Göteborg
- 58° - Stavanger
- 59° - Stockholm
- 60° - Helsinki

16: Codes (Display and selection):

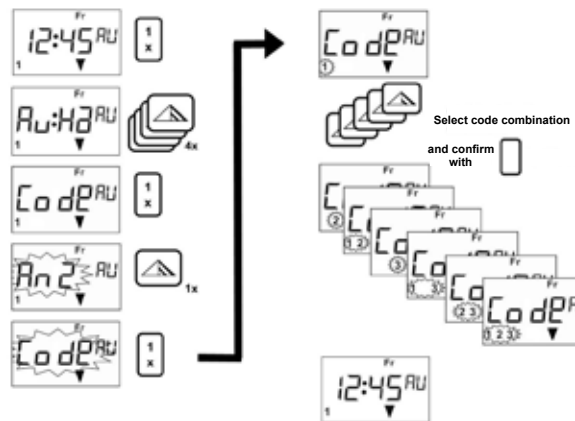

17: Grun (basic settings):

All settings are deleted !

Back to initial setting:
time and date must be reset.

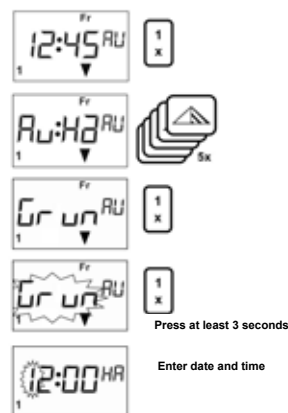

18: Urlb (activate/deactivate holiday function):

